



产品特点 PRODUCT FEATURES

- MF系列UPS电池, 高功率极板设计, 具有高倍率放电能力, 重量轻、比能量高, 内阻低, 充电接受能力强, 稳定性及一致性高, 安装灵活、维护便捷等特点。
- MF Series UPS battery, high power plate design, with high discharge capacity, light weight, high energy density, low internal resistance, charge acceptance ability, stability and high consistency, flexible installation, maintenance, convenient features.

规格型号 SPECIFICATION

Temperature: 25°C

额定电压 Nominal Voltage	12V
额定容量 Nominal Capacity (20 hour-rate to 1.80V/Cell)	24Ah
尺寸 Dimension (Length*Width*Height)	166*175*125mm
参考重量 Approx Weight	7.2Kg
参考内阻 Internal Resistance	14.2mΩ
运行温度范围 Operating Temperature Range	Charging: 0 to 40°C Discharge: -20 to 55°C Storage: -15 to 50°C
温度对容量的影响 Capacity affected by Temperature	40°C 105% 25°C 100% 0°C 86%
浮充电压 Float Charging Voltage	13.5 to 13.8V; Recom. 13.6V
循环使用充电电压 Cycle Use Charging Voltage	14.4 to 15.0V; Recom. 14.7V
浮充温度补偿系数 Float Charging Temp. Coefficient	-18mV/°C
循环使用温度补偿系数 Cycle Use Charging Temp. Coefficient	-30mV/°C
最大充电电流 Max. Charging Current	7.2A
最大持续放电电流 Max. Continuous Discharge Current	96A
月自放电率 Month Self Discharge	2% (20°C)
标准端子 Terminal	T3/T12 (M5)
外壳 Container Material	ABS (UL94-HB)

应用范围

APPLICATION

适用于小型UPS、灯具、衡器、仪器设备、信号控制、消费类产品配套电源等

For small UPS, lamps, scales, equipment, signal control, power supply and other consumer products supporting

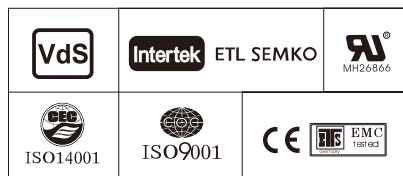

恒流放电表 Constant Current Discharge (安培Amperes)

Temperature: 25°C

Time F.V.(V/Cell)	5min	10min	15min	20min	30min	45min	1h	1.5h	2h	3h	4h	5h	6h	8h	10h	20h
1.85	60.2	41.6	32.9	26.9	20.2	15.0	12.7	9.48	7.59	5.68	4.50	3.75	3.22	2.56	2.09	1.14
1.80	70.2	49.0	38.3	31.0	22.9	16.8	14.0	10.4	8.26	6.15	4.85	4.04	3.46	2.74	2.23	1.20
1.75	76.6	52.6	40.5	32.5	23.9	17.4	14.6	10.7	8.51	6.31	4.97	4.13	3.53	2.79	2.27	1.22
1.70	83.0	56.1	42.8	34.2	24.9	18.1	15.1	11.1	8.78	6.50	5.09	4.22	3.60	2.84	2.30	1.23
1.67	86.7	58.1	44.1	35.2	25.6	18.5	15.4	11.3	8.93	6.59	5.16	4.27	3.65	2.86	2.32	1.24
1.60	95.5	62.9	47.3	37.4	27.0	19.5	16.2	11.8	9.30	6.84	5.34	4.41	3.75	2.93	2.37	1.26

恒功率放电表 Constant Power Discharge (瓦Watts/单格Cell)

Temperature: 25°C

Time F.V.(V/Cell)	5min	10min	15min	20min	30min	45min	1h	1.5h	2h	3h	4h	5h	6h	8h	10h	20h
1.85	115	79.6	63.2	51.8	39.1	29.1	24.7	18.5	14.8	11.14	8.84	7.38	6.35	5.05	4.14	2.26
1.80	132	92.9	72.8	59.1	43.8	32.3	27.1	20.1	16.1	12.01	9.49	7.92	6.80	5.40	4.41	2.38
1.75	142	98.5	76.2	61.4	45.4	33.3	27.9	20.7	16.5	12.27	9.69	8.08	6.92	5.48	4.47	2.41
1.70	152	104	79.7	64.0	47.0	34.3	28.7	21.2	16.9	12.57	9.90	8.24	7.05	5.57	4.53	2.44
1.67	157	107	82.3	65.4	47.9	34.9	29.2	21.5	17.1	12.73	10.0	8.32	7.12	5.62	4.57	2.46
1.60	171	114	86.2	68.7	50.0	36.3	30.3	22.3	17.7	13.12	10.3	8.54	7.29	5.73	4.65	2.50

F.V.(V/Cell): 终止电压(V/单格)

尺寸 Dimensions (mm)

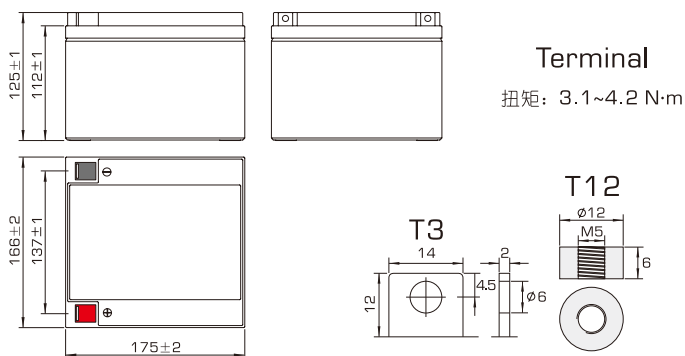

放电特性曲线

Discharge characteristics

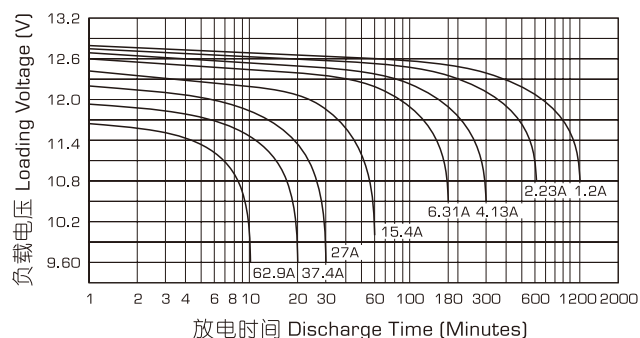

开路电压与容量关系

Open Voltage-remaining Capacity

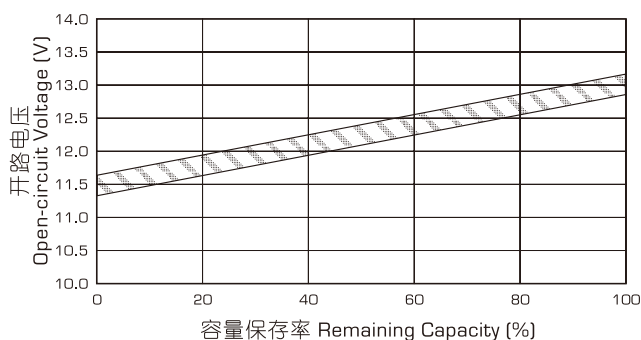

自放电特性曲线

Self discharging characteristics

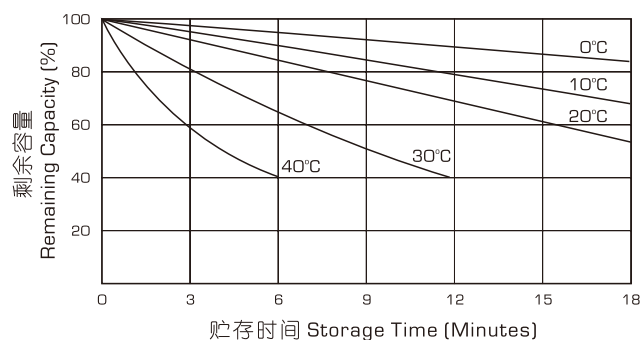

浮充使用充电特性

Float charging characteristics

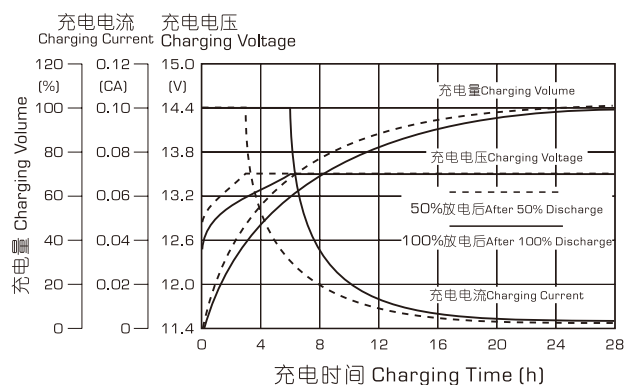

循环使用充电特性

Cycle use charging characteristics

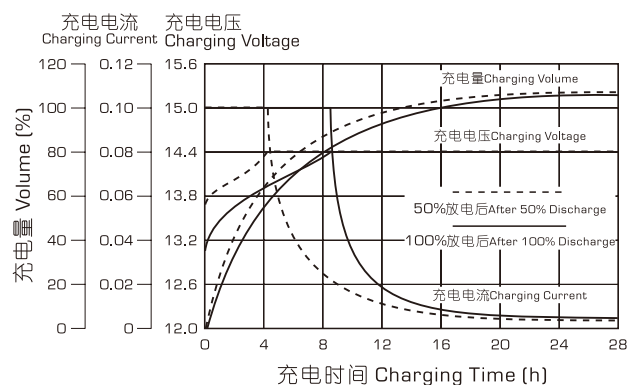

Battery storage temperature and charging time interval

Storage temp.	Supplementary charge interval	Charging methods
Less than 20°C	9 months	a) Using 2.25 ~ 2.30V / cell constant current limiting 0.15CA charge 2 to 3 days; b) with 2.35 ~ 2.40V / single cell constant current limiting 0.15CA charge 10 to 16 hours;
20 to 30°C	6 months	c) with a constant current charge 0.1CA 8 to 10 hours;
30 to 40°C	3 months	D) with the matching Smart charger to turn lights; Can choose one of four methods

Cautions:

- ※ Do not use batteries for application other than those specified in its specification.
- ※ Do not attempt to disassemble, revised, damaged, impacted, disposed batteries, otherwise the battery would be leaked, heated, exploded.
- ※ Do not dispose of the batteries in water, fire, and do not heating the batteries.
- ※ Do not short batteries
- ※ If the voltage of battery back is above 45V, please be sure wear the insulated glove in working, otherwise, it may be get an electronic shock.
- ※ There are sulfuric acid in the battery, do not contact with sulfuric acid in skin, cloths, especially in eyes. If eyes contact with sulfuric acid, please wash with a lot of clean water and consult a physician immediately